



EU-TYPE EXAMINATION CERTIFICATE

Equipment intended for use in Potentially Explosive Atmospheres Directive 2014/34/EU

Certificate Number: **CSANe 23ATEX1166X** Issue: **0**

Equipment: **Model C2201 Explosion-proof IP Camera**

Applicant: **TOP HI-TECH CO., LTD.**

Address: **9F, No. 1, Zhongshan Road
Tucheng Dist
New Taipei City
236, Taiwan (R.O.C)**

This equipment and any acceptable variation thereto is specified in the schedule to this certificate and the documents therein referred to.

CSA Group Netherlands B.V., notified body number 2813 in accordance with Articles 17 and 21 of Directive 2014/34/EU of the European Parliament and of the Council, dated 26 February 2014, certifies that this equipment has been found to comply with the Essential Health and Safety Requirements relating to the design and construction of equipment intended for use in potentially explosive atmospheres given in Annex II to the Directive.

The examination and test results are recorded in the confidential reports listed in Section 14.2.

Compliance with the Essential Health and Safety Requirements, with the exception of those listed in the schedule to this certificate, has been assured by compliance with the following documents:

EN IEC 60079-0:2018 EN 60079-1:2014/AC:2018-09 EN 60079-31:2022

If the sign 'X' is placed after the certificate number, it indicates that the equipment is subject to Specific Conditions of Use identified in the schedule to this certificate.

This EU-Type Examination Certificate relates only to the design and construction of the specified equipment. If applicable, further requirements of this Directive apply to the manufacture and supply of this equipment.

The marking of the equipment shall include the following:



II 2GD

Ex db IIC T6 Gb

Ex tb IIIC T80°C Db

Ta = -20°C to +50°C

Signed: M Halliwell

Title: Director of Operations



Project Number 80176039

8This certificate and its schedules may only be reproduced in its entirety and without change
CSA Group Netherlands B.V. Utrechtseweg 310, Building B42, 6812AR Arnhem, The Netherlands



SCHEDULE

EU-TYPE EXAMINATION CERTIFICATE

CSANe 23ATEX1166X

Issue 0

13 DESCRIPTION OF EQUIPMENT

Model C2201 Explosion-proof IP Camera, final enclosure consists of one aluminium base, two aluminium covers, and a glass window. The glass window secured between one cover and base. On the other cover provided with either a M25 or M20 cable entry. Inside the enclosure, utilized a Camera module (See controlled drawing EX-THT-C2201-014), provided with a camera gasket to cover two of the infra LEDs. The enclosure incorporates two flanged flameproof joints. One is between the cover and base, the other one is between glass window and cover, each provided with a gasket secured by glue in the groove for ingress protection. Four fasteners secured each cover to the base.

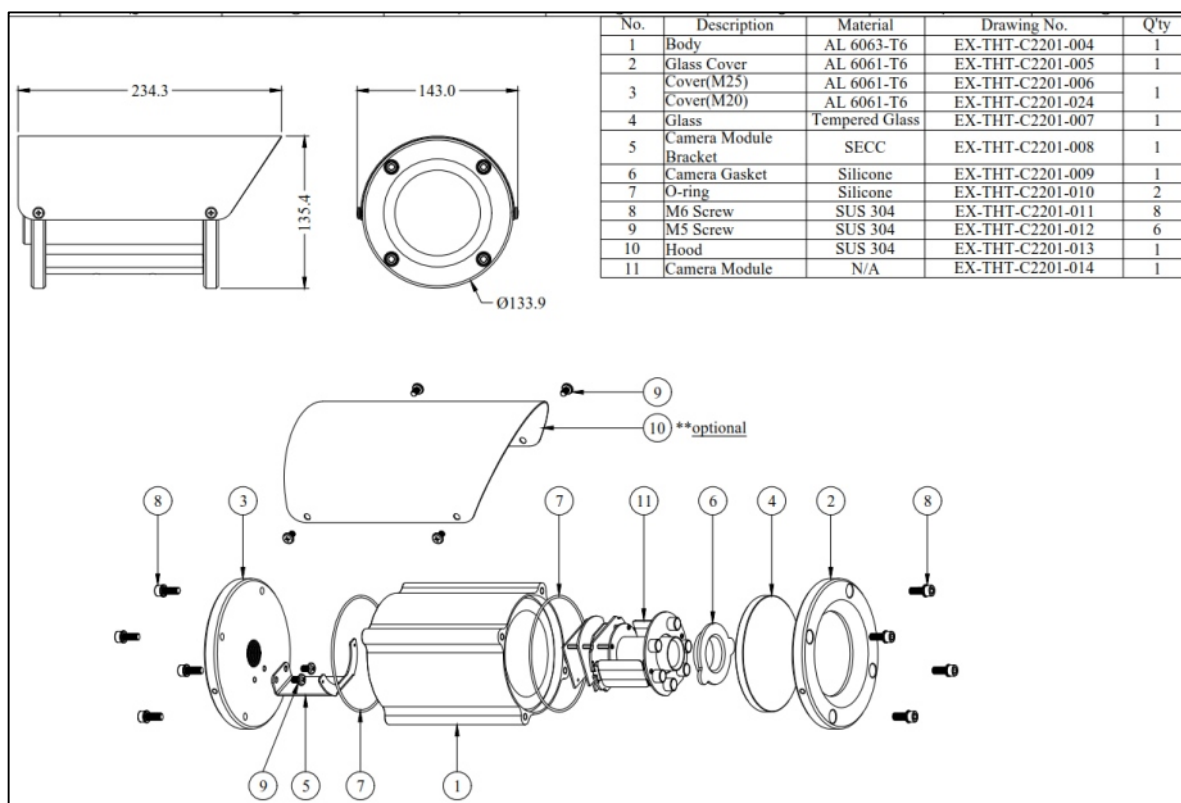

14 DESCRIPTIVE DOCUMENTS

14.1 Drawings

Refer to Certificate Annexe.

14.2 Associated Reports and Certificate History

Issue	Date	Report number	Comment
0	11 March 2024	R80176038A	The release of the prime certificate.

Project Number 80176038

This certificate and its schedules may only be reproduced in its entirety and without change
CSA Group Netherlands B.V. Utrechtseweg 310, Building B42, 6812AR Arnhem, The Netherlands



SCHEDULE

EU-TYPE EXAMINATION CERTIFICATE

CSANe 23ATEX1166X
Issue 0

- 15 **SPECIFIC CONDITIONS OF USE** (denoted by X after the certificate number)
- 15.1 For either M25 or M20 cable entry, must apply Ex cable glands certified for both IECEx and ATEX, with Min. protection levels of both Ex db IIC and Ex tb IIIC, and make sure Ex cable gland assembled Model C2201 still meet the assigned T-codes as shown in the markings.
- 16 **ESSENTIAL HEALTH AND SAFETY REQUIREMENTS OF ANNEX II** (EHSRs)
- The relevant EHSRs that are not addressed by the standards listed in this certificate have been identified and individually assessed in the reports listed in Section 14.2.
- 17 **CONDITIONS OF MANUFACTURE**
- 17.1 The use of this certificate is subject to the Regulations Applicable to Holders of CSA Group Netherlands B.V. certificates.
- 17.2 Holders of EU-Type Examination Certificates are required to comply with the conformity to type requirements defined in Article 13 of Directive 2014/34/EU.

Project Number 80176038

This certificate and its schedules may only be reproduced in its entirety and without change
CSA Group Netherlands B.V. Utrechtseweg 310, Building B42, 6812AR Arnhem, The Netherlands

Certificate Annexe



Certificate Number: CSANe 23ATEX1166X
Equipment: Model C2201 Explosion-proof IP Camera
Applicant: TOP HI-TECH CO., LTD.

Issue 0

Drawing	Sheets	Rev.	Date (Stamp)	Title
EX-THT-C2201-001	1 of 1	02	20 Feb 24	General Drawing
EX-THT-C2201-002	1 to 2	02	20 Feb 24	Construction Drawing
EX-THT-C2201-003	1 of 1	02	20 Feb 24	Nameplate
EX-THT-C2201-004	1 of 1	01	20 Feb 24	Body
EX-THT-C2201-005	1 of 1	01	20 Feb 24	Glass Cover
EX-THT-C2201-006	1 of 1	01	20 Feb 24	Cover with a M25 cable entry
EX-THT-C2201-007	1 of 1	01	20 Feb 24	Glass
EX-THT-C2201-008	1 of 1	01	20 Feb 24	Camera Module Bracket
EX-THT-C2201-009	1 of 1	01	20 Feb 24	Camera Gasket
EX-THT-C2201-010	1 of 1	01	20 Feb 24	O-ring
EX-THT-C2201-011	1 of 1	01	20 Feb 24	M6 Screw
EX-THT-C2201-012	1 of 1	01	20 Feb 24	M5 Screw (optional)
EX-THT-C2201-013	1 of 1	01	20 Feb 24	Hood (optional)
EX-THT-C2201-014	1 of 1	01	20 Feb 24	Camera Module
EX-THT-C2201-024	1 of 1	01	20 Feb 24	Cover with a M20 cable entry

Project Number 80176038

This certificate and its schedules may only be reproduced in its entirety and without change
CSA Group Netherlands B.V. Utrechtseweg 310, Building B42, 6812AR Arnhem, The Netherlands