

Operating Instructions

Explosion-proof IP Camera

Model C2201

THT-EX

Drawing No: RD-EX-C2201-A

Revision Level: A0

Date: 2024.03.25

Top Hi-Tech Co., Ltd.
9F, No. 1, Zhongshan Rd.,
Tucheng District,
New Taipei City, 236 Taiwan

Website: www.tht-ex.com
TEL: +886 2 22671234
FAX: +886 2 22691166
e-mail: sales@tht-ex.com



Contents

1. General Safety Instructions	1
2. Intended Field of Application.....	1
3. Technical Data	2
4. Model code.....	2
5. Dimension	2
6. Assembly and Installation	2-4
7. Maintenance	4
8. Accessories and Spare Parts	4
9. Transport, Storage and Disposal	4

1. General Safety Instructions

WARNING

This manual contains basic safety instructions to be observed during installation, operation and maintenance of the apparatus, and for properly and safety run of the apparatus according to its performance data. Any damage of the apparatus may result explosion protection null and void. This manual represents the most relevant information about the product, applicable codes and regulations shall supplement it. Non-observance will endanger persons, plant and the environment. The person in charge is required to secure its employment in the industrial unit. Any improper usage, as well as non-compliance with the rules under this manual, shall release the manufacturer's all responsibilities.

WARNING – The IP Camera shall not be opened.

WARNING – The flameproof joints are not intended to be disassembled or repaired.

WARNING – Potential Electrostatic Charging Hazard.

WARNING – Do not clean or rub when an explosive atmosphere may be present.

1.1 Before assembly/commissioning:

- ☞ Read through the operating instructions.
- ☞ Give adequate training to the assembly and operating personnel.
- ☞ Ensure that the contents of the operating instructions are fully understood by the personnel in charge.
- ☞ The national installation and assembly regulations (e.g. IEC 60079-14) apply.

1.2 When operating the device:

- ☞ Ensure the operating instructions are made available for the person in charge on location at all times.
- ☞ Observe these instructions, other working instructions and national safety regulations.
- ☞ Verify the implementation of safety instructions.

2. Intended Field of Application

The Explosion-proof IP Camera, Model C2201 is intended for using in gas explosive atmospheres (Zone 1 according to IEC 60079-10-1) and dust explosion hazards (Zone 21 according to IEC 60079-10-2). The use in other potentially explosive atmospheres does not correspond to the designated use and is therefore not allowed. The apparatus is designed for using in indoor and outdoor environments.

3. Technical Data

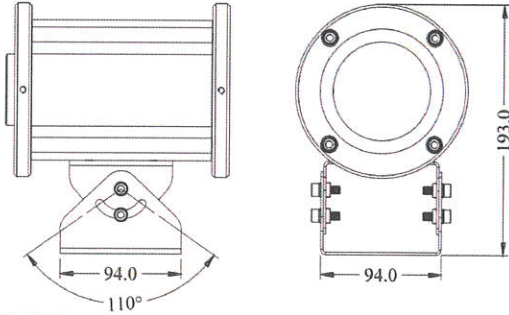
Item	Description
Explosion Protection IECEX	IECEX CSAE 23.0051X
Gas Explosion Protection	Ex db IIC T6 Gb
Dust Explosion Protection	Ex tb IIIC T80°C Db
ATEX	CSANe 23ATEX1166X
Gas Explosion Protection	CE0035 II 2 G Ex db IIC T6 Gb
Dust Explosion Protection	CE0035 II 2 D Ex tb IIIC T80°C Db
Power Supply	PoE+ (IEEE 802.3at compliant)
Power Consumption	PoE+, 15W
Ambient Temperate Range	-20°C ≤ Ta ≤ +50°C
Degree of Protection	IP67
Cable Entry Hole	M25x1.5P (Cable glands must be Ex db/Ex tb approved by IECEX/ATEX)
Mounting Type / Weight	Projection (RO)
	
4.0 kg (without hood) / 4.5 kg (with hood)	

4. Model Code

THTC2201ACLZEA5

5. Dimensions (All Dimensions in mm)

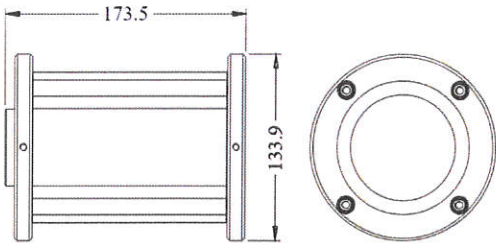
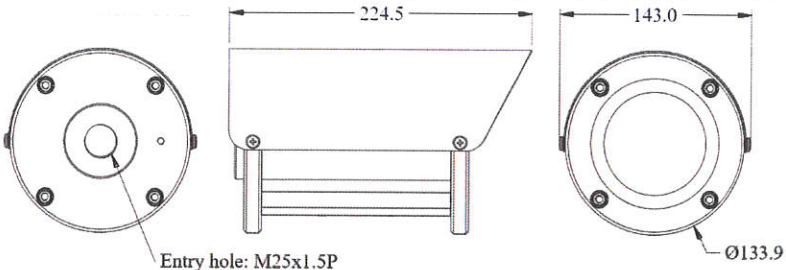
Without hood (3.7 kg)	With hood (4.1 kg)
	

6. Assembly and Installation

6.1 System Architectures

For connecting IP Camera series to the network, please follow one of the system architectures

1. Use with PoE of the network switch connected to the network.

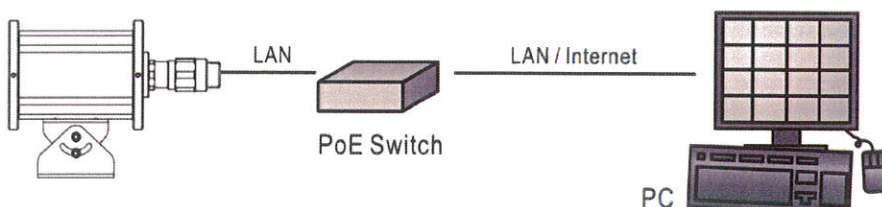

2. Use PoE power injector and the network switch connected to the network.

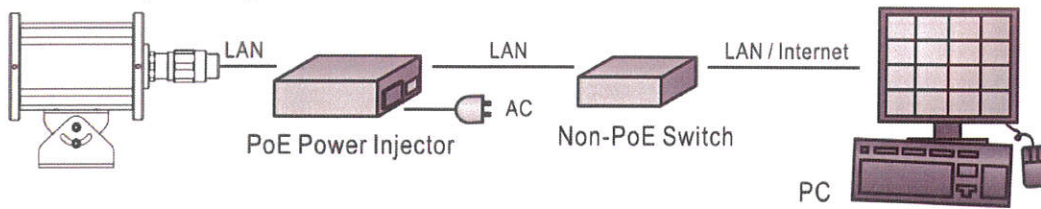

Before Accessing IP Cameras

Before accessing the IP camera, make sure that the camera's RJ-45 network, audio, and power cables are properly connected. To set the IP address, consult your network administrator for an available IP address. The default IP address for each IP camera is 192.168.0.200. Users can use the default IP address for verifying the camera's network connection.

Factory Default

The factory default username and password:

Username: admin

Password: Tht-ex9999

The factory default IP address: 192.168.0.200

Software Requirements

Universal ActiveX software components are required for web interface display of JPEG or Full HD video.

When you login to the IP camera by Internet Explorer, the security warning dialog box will prompt the installation of the Universal ActiveX. Click Install to download it.

Configuring IP Addresses via Web Interface

To change an IP address via web interface, type the default IP address (192.168.0.200) in the Internet browser and follow the steps below:

1. Login to the HD IP camera with the set username and password.
2. Click Basic Mode configuration hyperlink.
3. Click Network->General hyperlink.
4. Change the IP address, subnet mask, gateway, or HTTP port for the IP camera.
5. Click Submit to verify the settings.



Login

To login to the Full HD IP camera, please set the username and password on the login page.

Press [Login] to complete the setting and login simultaneously.

Username: admin

Password: Tht-ex9999



6.2 Mounting Bracket Installation

6.2.1 Projection (RO)

- Position the bracket holders and fix it by means of the provided M6 screws, 24.5kgf-cm (M6).
- Secure the projection mounting bracket to the structure by using three fasteners (not provided).

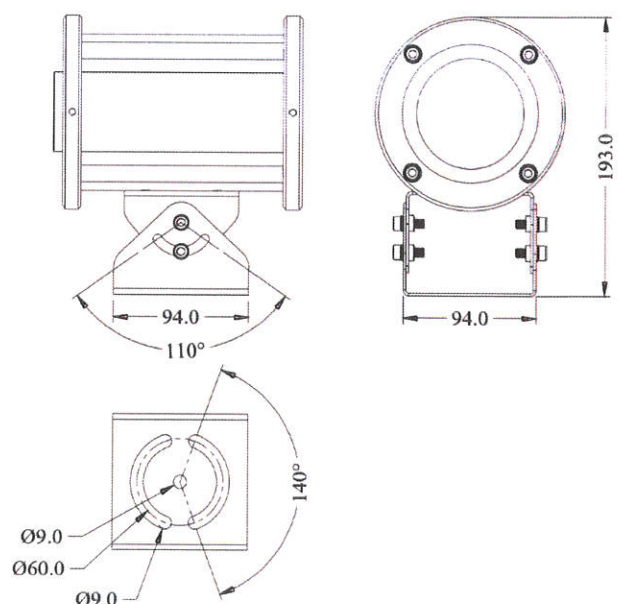

6.3 Earth ground

External earth ground

- ☞ The external ground screw is not provided.
- ☞ Terminal type as show the right pictures.
- ☞ Ground wire cross-sectional area=4 mm².
- ☞ Both ground screw and washer material is stainless steel.
- ☞ Screw hole spec: M5.
- ☞ Torque requirement: 14.5 kgf-cm.
- ☞ Ensure wire is tied assured.

6.4 Putting into Service

Before putting into operating, it's necessary to ensure that:

- ☞ the IP Camera is correctly installed.
- ☞ the connection has been correctly made.
- ☞ the cable has been inserted correctly.

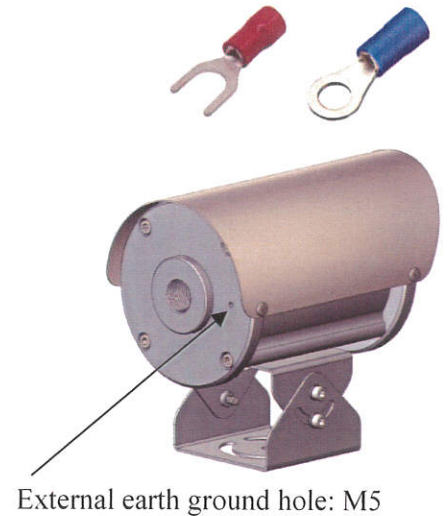

7. Maintenance

⚠ WARNING

- ▶ To avoid dangers due to energized parts, all connections and wiring must be disconnected from the power supply. Secure the connections against unauthorized activation.
- ▶ To avoid risk of burn to hands, let the IP Camera cool down for approximate 30 minutes before touching them.
- ▶ Repairs are only to be carried out by the manufacturer. Unauthorized repair shall cause the manufacturer's liability and warranty expires.
- ▶ To avoid danger of potential electrostatic charging hazard, please wipe with a damp cloth when cleaning.

Regular Maintenance

- ☞ Consult the relevant national regulations (e.g. IEC 60079-17) to determine the type and extent of inspections.
- ☞ Arrange the plan of regular inspection with the equipment, one time per 3-month at least, so that any defects in the equipment which may be anticipated are promptly detected.

To check as part of the maintenance schedule as following:

- ☞ Cracks or damages on the glass cover and/or on the enclosure.
- ☞ Condition of the connecting cables.
- ☞ Screws of the mounting bracket are tightened.



8. Accessories and Spare Parts

⚠ WARNING

Use only original THT-EX accessories and spare parts. For accessories and spare parts, see data sheet at www.tht-ex.com.

9. Transport, Storage and Disposal

- ☞ Transport and storage are only allowed in the original packaging, on the way pointed out on the carton box.
- ☞ Transport – Shock-free in its original carton, do not drop, and handle carefully.
- ☞ Store – Store in a dry place in its original packaging.
- ☞ Disposal – Ensure environmentally friendly disposal of all components according to the legal regulations.