

L1733NS Hazardous Location LED Lighting

Optional: Sensing Device
(Daylight or Occupancy Sensor)

CID2
Group
A, B, C, D

IP67

NEMA
6

Protection

- Class I, Division 2,
Groups A, B, C, D

Standards

UL 844
UL 1598 Luminaires
UL 8750
CSA C22.2 No. 137-18
CSA C22.2 No. 250.0
CSA C22.2 No. 250.13

Net Weight: 13.0 kg (28.7 lb)

Lens Angle

30°, 60°, 90°, 120°, 149°*(25°+90°)

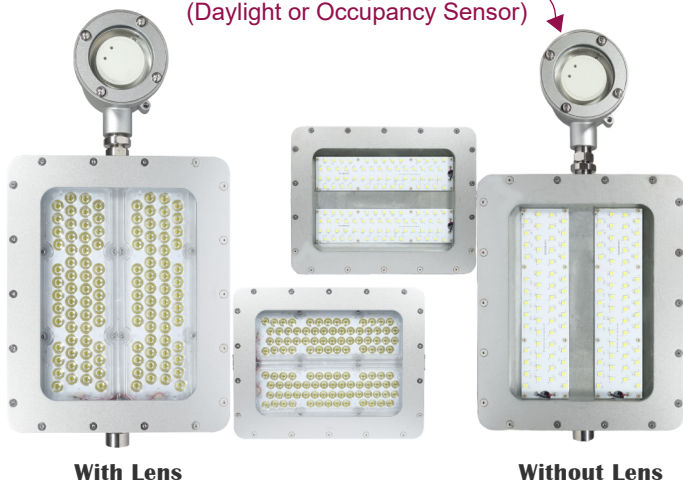

With Lens

Without Lens

Technical Data

*Please specify the required lens angle when ordering.

Rated Voltage (±10%)	100~277AC (Full Volt.)
Watts (±10%)	100W / 110W / 120W / 130W / 140W / 150W / 160W / 170W / 180W / 190W / 200W
Ambient Temperature	-20°C ~ +50°C ,T6(100W~150W) / -20°C ~ +40°C ,T3C(160W~200W)
Amps	0.36A~1.50A
Color of LED Light	3000K (Warm White) / 5000K (Cool White)
Power Factor	cos≥0.9
CRI	Cool White≥70 / Warm White≥80
Lumen (±10%)	≥ 135 lm
Frequency	50 / 60 Hz
Degree of Protection	IP67 / NEMA 6
Material	<ul style="list-style-type: none"> Enclosure: Aluminum alloy Glass: Tempered glass
LED Service Life	60,000 hrs
Entrance Thread	1 × NPT 3/4"

Daylight Sensor: Digital data control ambient light sensor

Sensing Range	Approx. 2~2,000 lux (0.2~200 fc)
Field of View	Approximate 80°

Occupancy Sensor: Detection Pattern

Mounting Height	3 m (10 ft)	6 m (20 ft)
Coverage*	180 m² (2,000 ft²)	100 m² (1,200 ft²)

*Sensitivity 100%

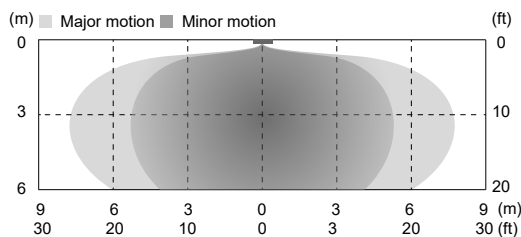

Lens Angle

UNIT: cd
— C0/180
— C90/270

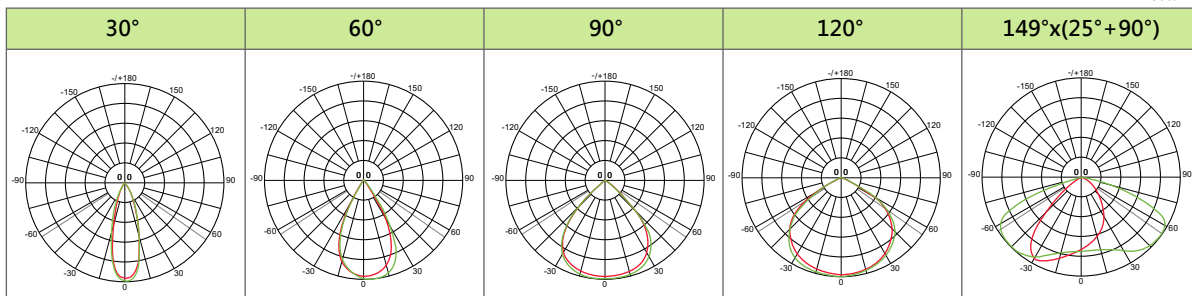

Model Code

THT H 1733S S K C H P0 01 WHT

①

②

③

④

① Sensor

S =With Sensor
Z =Without Sensor

② C.C.T.

C =Cool White
W =Warm White

③ Wattage

J0=100W, K0=110W, L0=120W,
M0=130W, N0=140W, P0=150W,
Q0=160W, R0=170W, S0=180W,
T0=190W, U0=200W

④ Mounting Bracket Type

WHT(W90)=Wall Mount 90°
WHT(H90)=Hanging Mount 90°
RO=Rotatable
SL=Street Light



Mounting Option & Dimensions (All in mm)

Wall Mount 90° [WHT(W90)]

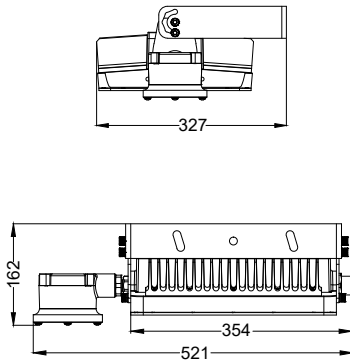

14.2 kg (31.3 lb)

Street Light (SL)

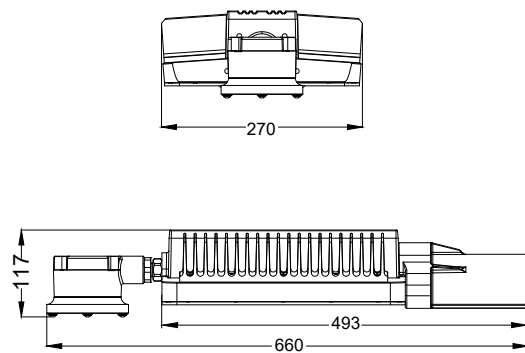

14.1 kg (31.1 lb)

Rotatable (RO)

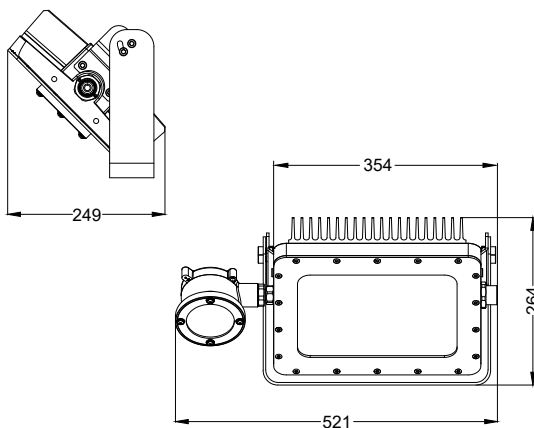

14.2 kg (31.3 lb)

Hanging Mount 90° [WHT(H90)]

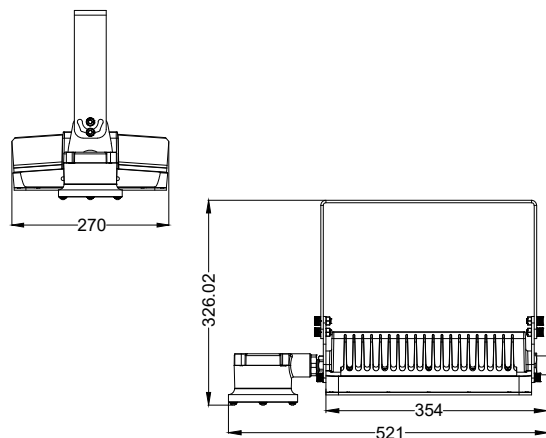

14.2 kg (31.3 lb)